



**BRIDAS EMI GROUP S.A.**



**BRIDAS EMI GROUP S.A.**

**Table 4: STEEL BACKING FLANGES**  
**AS/NZS 4331.1 (ISO 7005-1) – Table 10**  
**PN10**

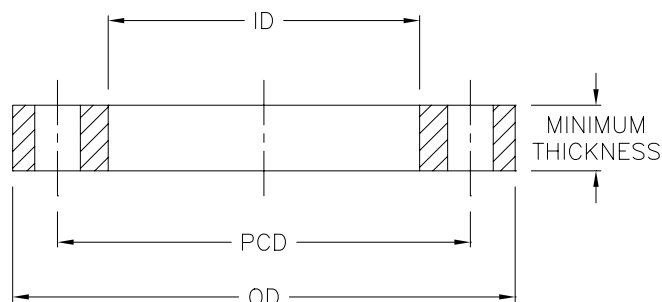

Nominal Pipe OD	Flange Size	OD	ID	Minimum Thickness	PCD	Bolt Hole No. x Dia.	Bolt Size
20	15	Refer Table 5					
25	20						
32	25						
40	32						
50	40						
63	50						
75	65						
90	80						
110	100						
125	100						
140	125						
160	150						
180	150						
200	200	340	235	24	295	8X22	M20
225	200	340	238	24	295	8X22	M20
250	250	395	288	26	350	12X22	M20
280	250	395	294	26	350	12X22	M20
315	300	445	338	28	400	12X22	M20
355	350	505	376	30	460	16X22	M20
400	400	565	430	32	515	16X26	M24
450	450	615	470	35	565	20X26	M24
450	500	670	517	38	620	20X26	M24
500	500	670	533	38	620	20X26	M24
560	600	780	618	42	725	20X29.5	M27
630	600	780	645	42	725	20X29.5	M27
710	700	895	740	-	840	24X29.5	M27
800	800	1015	843	-	950	24X32.5	M30
900	900	1115	947	-	1050	28X32.5	M30
1000	1000	1230	1050	-	1160	28X35.5	M33

As per ISO 9624: "The inside diameter of the loose backing flange shall conform to the design of the flange adaptor. In some applications, values of the inside diameter of the loose backing flange differing from those given in the tables may be used."



**BRIDAS EMI GROUP S.A.**

[info@bridasemi.com.ar](mailto:info@bridasemi.com.ar)

[www.bridasemi.com.ar](http://www.bridasemi.com.ar)

Rondeau 1560 Wilde, Buenos Aires. Argentina

Tel: 4220 -4414 4414 /4289 4572 - 4289 2030 / 4137 7325